

SITE PLAN (SCALE 1:1000)

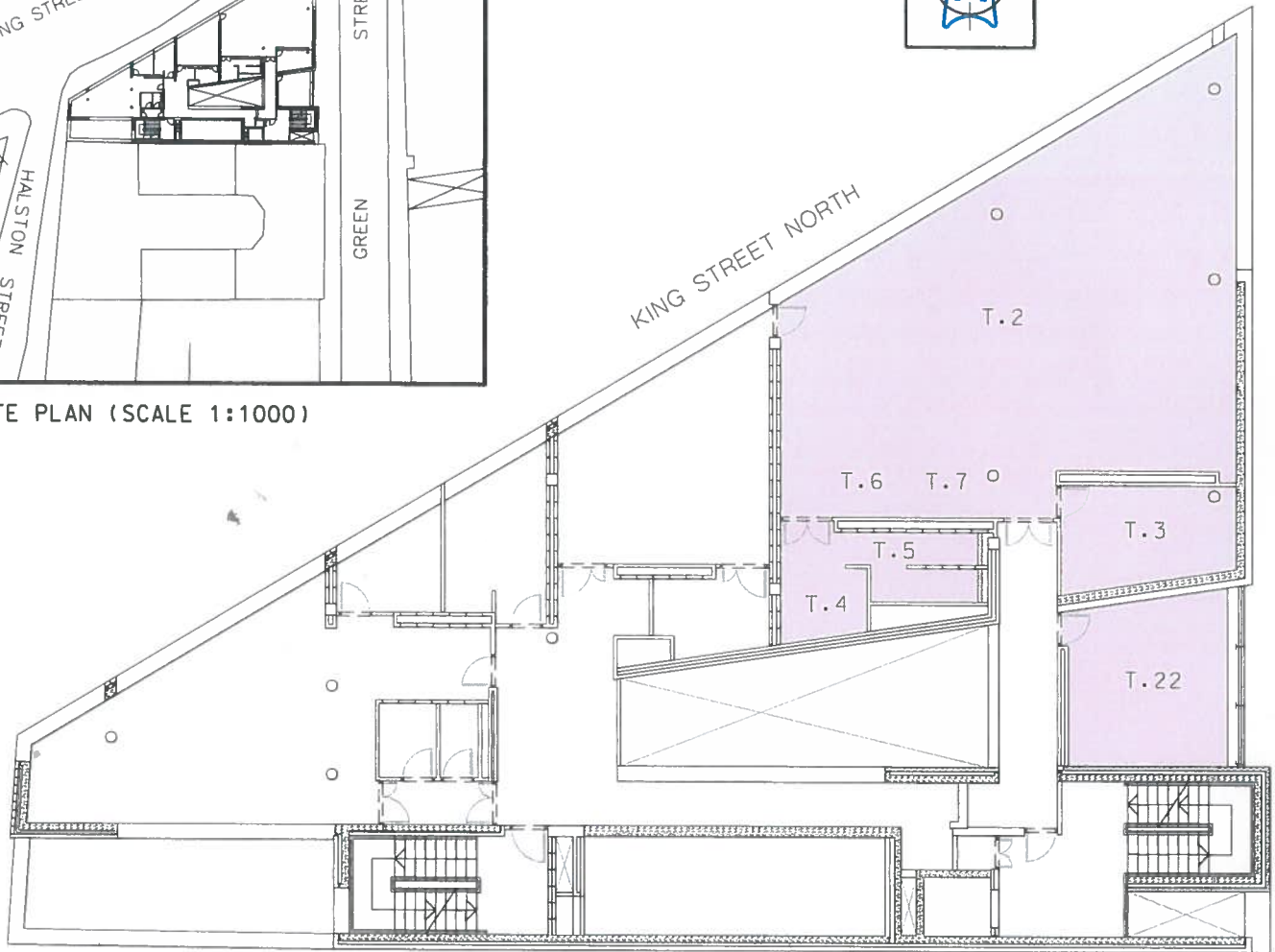

THIRD FLOOR PLAN (SCALE 1:200)

HALSTON STREET /NORTH KING STREET /GREEN STREET – MACRO BUILDING
Rooms T.02, T.03, T.04, T.05, T.06, T.07, T.22 (AREA: 161.5 sq m)
Dublin City Council to European Consumer Centre (Ireland) Limited
DISPOSAL OF LICENCE

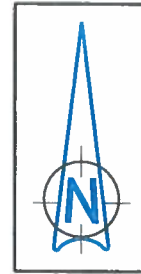

DUBLIN CITY COUNCIL

Comhairle Cathrach Bhaile Átha Cliath
ENVIRONMENT AND ENGINEERING DEPARTMENT
An Roinn Comshaoil agus Innealtóireachta
SURVEY AND MAPPING SERVICES DIVISION
Rannán Seirbhísi Suirbhéireachta agus Léarscailithe

O.S REF
3263-04, 3263-05

SCALE
1:1000 / 1:200

DATE 18.11.2010
REV: 09.08.2011
REV: 08.02.2013

**SURVEYED /
 PRODUCED BY**
TJC

INDEX No | FOLDER No | CODE | DWG No | REV

FILE NO SM-2010-0692_0204- C3 - 001 - B.dgn

FOR PROPERTY REGISTRATION AUTHORITY PURPOSES ONLY
 THIS MAP IS CERTIFIED TO BE COMPUTER GENERATED BY
 DUBLIN CITY COUNCIL FROM ORDNANCE SURVEY DIGITAL MAPBASE

INDEX No.

MICHAEL PHILLIPS
CITY ENGINEER

SIGNED _____
PATRICK SHINE
 MANAGER LAND SURVEYING & MAPPING
 DUBLIN CITY COUNCIL

SM-2010-0692-001